

Bissell®

BigGreen Commercial™

HERCULES MINI

CANISTER VACUUM CLEANER

USER GUIDE

MODEL: BGC1000



IMPORTANT SAFETY INSTRUCTIONS

When using an electrical appliance, basic precaution should always be followed, including the following:

READ ALL INSTRUCTIONS BEFORE USING (THIS APPLIANCE)

WARNING-To reduce the risk of fire, electric shock, or injury:

1. Do not leave vacuum cleaner when plugged in. Unplug from outlet when no use and before servicing.
2. To reduce the risk of electric shock, do not use outdoors or on wet surfaces
3. Use only as described in this manual. Use only manufactures recommend attachments.
4. Do not use with damaged cord or plug. If vacuum cleaner is not working as it should, has been dropped, damaged, left outdoors, or dropped into water, enter it to a service center.
5. Do not pull or carry on cord, use cord as a handle, close door on cord, or pull cord around sharp edges or corners. Do not run vacuum cleaner over cord. Keep cord away from heated surfaces.
6. Do not unplug by pulling on cord. To unplug, grasp the plug, not the cord.
7. Do not handle plug or vacuum cleaner with wet hands.
8. Do not put any object into openings. Do not use with any opening blocked. Keep free of dust, lint, hair and anything that may reduce airflow.
9. Keep hair, loose clothing, fingers and all parts of body away from openings and moving parts.
10. Turn all controls off before unplugging.
11. Use extra care when cleaning on stairs.
12. Do not use to pick up flammable or combustible liquids, such as gasoline, or use in areas where they may be present
13. Hold plug when rewinding onto cord reel. Do not allow plug to whip when rewinding.
14. Unplug before connecting the hose
15. Do not pick up anything that is burning or smoking, such as cigarettes, matches, or hot ashes.
16. Do not use without dust bag and/or filter in place.
17. If the supply cord is damaged, it must be replaced by the manufacturer or its service agent or a similarly qualified person in order to avoid a hazard.

SAVE THESE INSTRUCTIONS!

1. Main Parts List

1. Handle
2. Power switch
3. Button
4. Dust container
5. Suction hose connector
6. Cover of dust container
7. Air slide
8. Handle
9. Hose
10. Extension tube
11. Floor brush
12. Power cord
13. Crevice nozzle
14. Upholstery nozzle
15. Round brush with horse hair

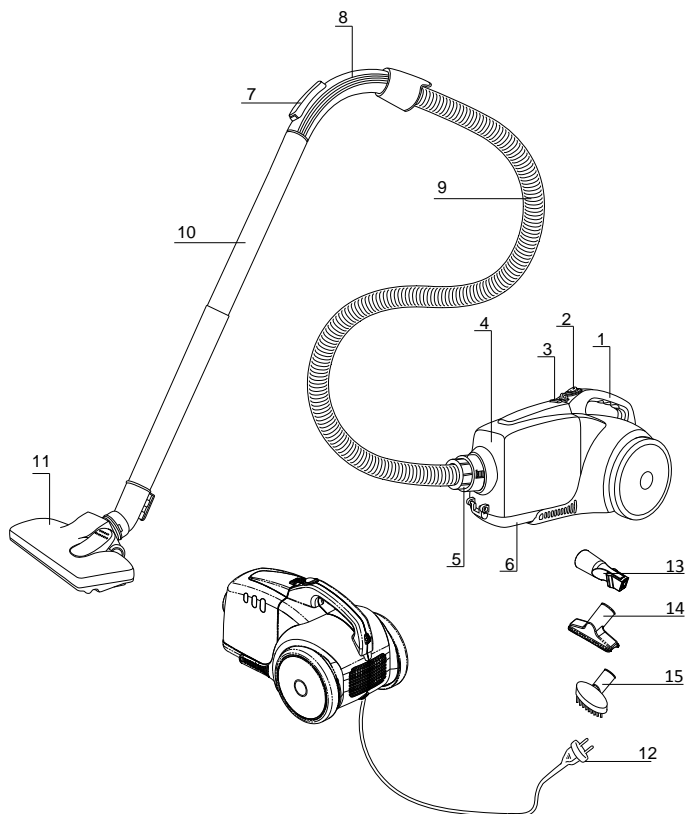

2. PREVENTION

Switch off the vacuum cleaner immediately if the air intakes, the floor brushes or the extension tube becomes blocked. Before starting the vacuum cleaner up again remove the substance causing the blockage:

1. Never use the vacuum cleaner in the immediate vicinity of hot bodies and do not suck up hot objects such as cigarette ends or ashes.

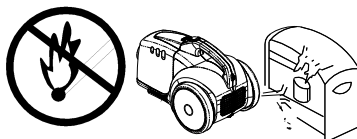

2. Only place the plug in the socket when your hands are dry.

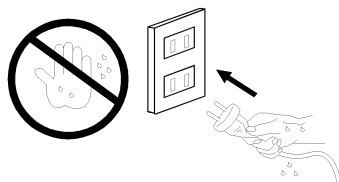

3. Please remove large or sharp objects from the floor before using the vacuum cleaner to avoid any possible damage to it.

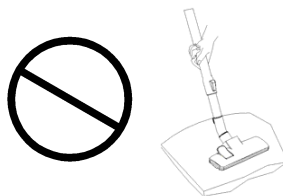

4. Do not pull by the mains cable when pulling out the plug.

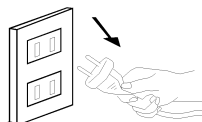

3. Assembly

Always remove the plug from the power socket before fitting or removing accessories.

Insert/remove the hose

Insert the flexible hose in the hose inlet duct on the top of the product. To do this, press the two connection buttons until it clicks into right position, then connect the extension tube to the handle end of the hose. Adjust the length of the extension tube by pushing the button on it, at last, fitting the floor nozzle to the end of extension tube.

Remove the hose, press the two same buttons on the end of the hose and pull it out the hose inlet duct, disconnect the extension tube and floor nozzle.

Usage of floor brush

Press the lever (A) for cleaning the hard floor.

Press the lever (B) for cleaning the carpets.

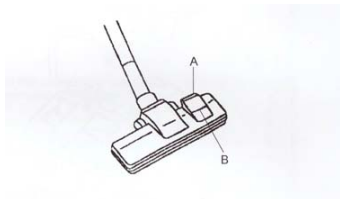

Suction control

The suction power can be adjusted by changing the position of the fingertip control on the handle tube.

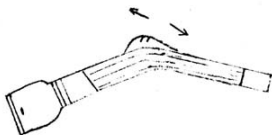

4. Operation Instructions

1). Power

Draw out power cord; Plug pin into the socket; Press the power switch;

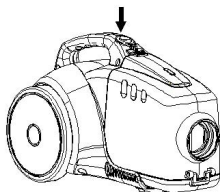

2). Dust Container loading

Loading the Dust Container vertically into the body according to the logo indication. When click sound, it is fit well.

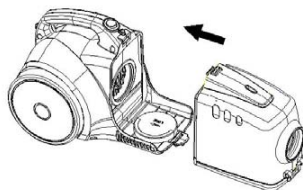

3. Dust Container unloading

1. Disconnect the hose by pressing the button of hose connector
2. pressing the button, and vertically take out the dust pod.

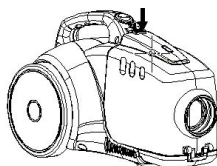

4. Emptying the dust container

1. Open the dust container cover by pushing the release latch.
2. After emptying it clean the HEPA filter if necessary

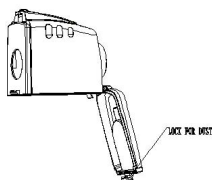

BISSELL® BigGreen Commercial™ Customer care

For information about repairs or replacement parts, or questions about your warranty, call:

BISSELL® BigGreen Commercial™ Customer Care
800-242-1378

Monday - Friday 8 am - 5 pm ET

Or write:

BISSELL® BigGreen Commercial™ Business Ventures, LLC.

100 Armstrong Rd Suite 101 Plymouth Ma 02360

ATTN: Customer Care

Or visit the BISSELL® BigGreen Commercial™ website -

www.bissellcommercial.com

When contacting BISSELL® BigGreen Commercial™, have model number of cleaner available.

Please record your Model Number: _____

Please record your Purchase Date: _____

Bissell®
BigGreen Commercial™

©2013 BISSELL® BigGreen Commercial™
Business Ventures, LLC.

100 Armstrong Rd Suite 101
Plymouth Ma 02360

All rights reserved. Printed in China

Part Number 160-0963

Rev 2/13

Visit our website at:

www.bissellcommercial.com